

**Power Electronics
Components
[Catalog]**



HIDUST®
Cores for Choke Coil, Choke Coil

HIDUST® core is powder magnetic core made of high performance metal powder. Those cores and coils are suitable for choke coil for power factor correction, step-up/step-down converters, secondary smoothing and EMI filters, and contribute to downsizing and high performance of electric power conversion system.

HIDUST® is a registered mark of Hitachi Ferrite Electronics, Ltd.



Materials Mag!c
Hitachi Metals

1. Features

1. High saturation resistance

Powder core using soft magnetic alloy is high resistance to over-current.

2. Low core loss

High performance soft magnetic alloy and our own process technology realizes low core loss.

3. Low audio noise*

Due to its composition with low magnetostriction, it allows reducing audible noise emission at audio-frequency excitation (20Hz~20kHz).

*Measured by Hitachi Metals, Ltd:

A-weight sound pressure level: 36dB at Bm=0.2T, and 10kHz

2. Standard Specifications

Table 1 HIDUST® Cores for Choke Coil

Operating temperature range:-25~+120°C (includes self temperature rise)

P/N	Dimensions(mm)			Le Typ. (mm)	Ae Typ. (mm ²)	AL Value ^{*2} Typ. (nH/N ²)	We Typ. (g)
	A MAX.	B MAX.	C MIN.				
DT-20	14.9	6.7	5.6	31.6	15.3	48.5	3
DT-22	18.6	8.0	8.8	41.3	23.3	56.8	7
DT-22W	18.8	14.2	8.6	41.3	44.6	108.5	12
DT-26	23.3	8.1	11.0	51.1	32.1	63.1	11
DT-26H	23.5	14.4	10.9	51.1	60.5	111.5	21
DT-28	25.1	9.4	10.6	51.9	45.5	88.1	17
DT-36S	28.4	8.8	13.6	62.3	43.7	70.5	19
DT-36	28.6	13.4	13.4	62.3	69.4	111.9	30
DT-40	34.9	14.2	18.5	80.5	79.3	86.7	42
DT-40H	35.1	19.8	18.3	80.5	108.5	110.1	58
DT-40W	35.3	27.4	18.1	80.5	158.6	173.4	85

Le: Mean magnetic path length, Ae: Effective sectional area, We: Weight

*Note 1: Outer diameter (A) is diameter of coated core

*Note 2: AL value is standard value for 20kHz at OA

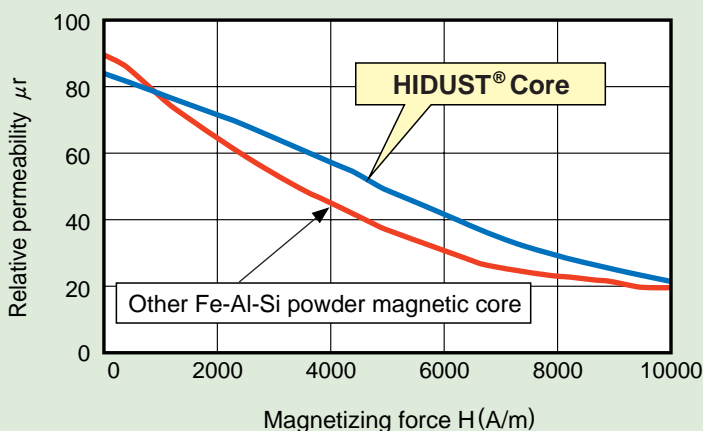

Fig.1 DC superposed characteristics

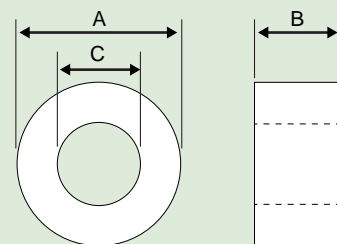

Fig.2 HIDUST® core for choke coil

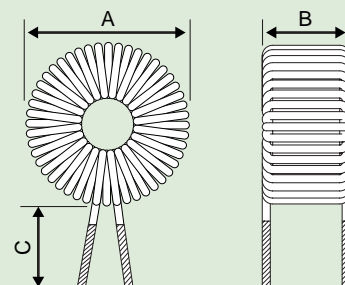

Fig.3 HIDUST® choke coil



For safety and the proper usage, you are requested to approve our product specifications or to transact the approval sheet for product specifications before ordering. This catalog and its contents are subject to change without notice.

Table 2 HIDUST® Choke Coil

Operating temperature range:-25~+120°C (includes self temperature rise)

P/N	Rated current (A)	Inductance L (μH) +25%/-20%		Wire diameter φ (mm)	Dimensions (mm)			DC resistance Typ. (mΩ)	W _e Typ. (g)
		at 0A	at rated current		A MAX.	B MAX.	C ±5		
DT-201	1	200	175	0.5	18.0	8.5	30.0	130	7
DT-202	2	60	50	0.7	18.5	10.5	30.0	40	7
DT-203	3	30	27	0.8	19.0	10.5	30.0	20	7
DT-221	1	550	475	0.5	21.0	11.5	30.0	210	11
DT-222	2	165	135	0.7	21.0	12.0	30.0	60	12
DT-223	3	105	85	0.8	21.0	12.5	30.0	40	12
DT-225	5	42	32	1.0	22.0	12.0	30.0	15	13
DT-261	1	1000	850	0.5	25.0	12.5	30.0	325	18
DT-262	2	500	375	0.7	26.0	13.5	30.0	115	20
DT-263	3	175	135	0.8	26.5	13.5	30.0	50	18
DT-265	5	90	65	1.0	27.0	13.0	30.0	25	19
DT-362S	2	2000	1200	0.7	33.0	15.5	30.0	250	39
DT-363S	3	440	325	0.8	33.0	14.0	30.0	90	29
DT-365S	5	390	215	1.0	33.0	15.0	30.0	55	35
DT-366S	6	82	62	1.2	34.0	15.0	30.0	20	31
DT-3610S	10	55	37	1.6	35.0	16.0	30.0	9	38
DT-362	2	1300	1050	0.7	32.5	17.5	30.0	210	55
DT-363	3	310	275	0.8	32.5	18.0	30.0	75	39
DT-365	5	185	150	1.0	33.0	19.0	30.0	45	42
DT-366	6	60	50	1.2	34.0	18.0	30.0	18	40
DT-3610	10	42	35	1.6	35.0	20.0	30.0	8	46
DT-3620	20	50	24	1.8	35.0	21.0	30.0	8	54
DT-403	3	725	560	0.8	39.5	18.5	30.0	125	62
DT-405	5	625	390	1.0	39.5	20.0	30.0	75	67
DT-406	6	330	230	1.2	41.0	21.5	30.0	40	68
DT-408	8	320	180	1.4	41.0	23.0	30.0	30	75
DT-4010	10	150	90	1.6	41.0	22.0	30.0	16	70
DT-4020	20	33	21	1.8	41.0	22.0	30.0	8	62
DT-4021	20	20	15	1.6x2P	42.0	22.0	30.0	4	72
DT-4030	30	20	15 at 20A	1.8x2P	42.0	23.0	30.0	3	75
DT-406H	6	600	400	1.2	42.0	27.0	30.0	56	102
DT-4010H	10	220	140	1.6	43.0	27.0	30.0	21	107
DT-4020H	20	100	50	2.0	43.0	27.0	30.0	9	111
DT-406W	6	570	410	1.2	43.0	34.0	30.0	60	129
DT-4010W	10	300	200	1.6	43.0	35.0	30.0	25	142
DT-4020W	20	105	55	2.0	43.0	35.0	30.0	9	136



For safety and the proper usage, you are requested to approve our product specifications or to transact the approval sheet for product specifications before ordering. This catalog and its contents are subject to change without notice.

Hitachi Metals, Ltd. <http://www.hitachi-metals.co.jp>

Soft Magnetic Materials Company Head Office

2-1 Shibaura 1-chome, Seavans North Bldg.
Minato-ku, Tokyo 105-8614, Japan
Tel:+81-3-5765-4042 Fax: +81-3-5765-8313

Kansai Sales Office

5-29 Kitahama 3-chome, Nissei Yodoyabashi building
Chuo-ku, Osaka 541-0041, Japan
Tel:+81-6-6203-9751 Fax:+81-6-6222-3414

Chubu-Tokai Sales Office

13-19 Nishiki 2-chome, Takisada building, Naka-ku
Nagoya-shi, Aichi, 460-0003, Japan
Tel:+81-52-220-7470 FAX:+81-52-220-7486

Hitachi Metals America, Ltd.

Cicago Office

2101 S. Arlington Heights Road Suite 116
Arlington Heights, IL 60005-4142
Tel:847-364-7200 Fax:847-364-7279

Detroit Office

41800 W. Eleven Mile Road Suite 100
Novi, MI 48375-1818
Tel:248-465-6400 Fax:248-465-6020

Hitachi Metals Europe GmbH

Head Office

Immermannstrasse 14-16,
40210 Duesseldorf, Germany
Tel:+49-211-16009-57 Fax:+49-211-16009-60

Hitachi Metals Singapore Pte. Ltd.

12 Gul Avenue, Singapore 629656
Tel:+65-6861-7711 Fax:+65-6861-9554

Hitachi Metals (Shanghai) Ltd.

11F, Tian An Center, No.338 NanJing Road(West),
Shanghai, 200003, China
Tel:+86-21-6358-6334 Fax:+86-21-6431-8067

Hitachi Metals Hong Kong Ltd.

Units 2212-14, 22/F., Miramar Tower,
132 Nathan Road, Tsimshatsui,
Kowloon, Hong Kong
Tel:+852-2724-4183 Fax:+852-2311-2095

NOTICES

1. When designing a component using this product and applying the designed components in any system, use this product only in the guaranteed range specified by Hitachi Metals, Ltd. Do not use the product beyond guaranteed values specified by Hitachi Metals, Ltd. Hitachi Metals, Ltd. will not be responsible for any damage or accident when this product is used beyond guaranteed values specified by Hitachi Metals, Ltd. Even when the product is used within the specification given by Hitachi Metals, take appropriate measures for system, such as failsafe, to avoid any accident resulting in any bodily injury and/or property damage. It is the responsibility of a user to take such measures.
2. This product is designed to be used for general electronic devices (e.g. office machinery, communication devices, measurement devices, household appliances, etc.). Performance and safety of this product for applications in the special fields which require particularly high reliability and quality, and whose application is potentially life threatening or could lead to physical harm in the event of malfunction is not confirmed. Such fields may include: space science, aviation, nuclear energy, combustion control, transportation, safety devices and medical equipment. Be sure to examine the performance and safety when the product is used for these applications, and take appropriate measures for system, such as failsafe, to avoid any accident resulting in any bodily injury and/or property damage. It is the responsibility of a user to take such measures.
3. Take appropriate measures, such as using an overvoltage protective device to prevent high voltage surge from being applied to the product if direct lightning surge, inductive lightning surge, switching surge, etc. is likely to be applied to this product. This product may deteriorate in function when high-voltage surge is applied. It is the responsibility of a user to take such measures.
4. Do not use this product in devices under massive radiation, such as neutron rays. This product is not a radiation-proof and may result in deterioration of this product.
5. In no event shall Hitachi Metals, Ltd. be responsible for any claim, loss or damages caused by defect in design by user.
6. The products and their specifications are subject to change without notice.
Please check the latest catalog, technical documents or specifications before your final design, procurement or use of the products.
7. No warranty, right or license in connection with any patent, trademark, copyright, or any other intellectual property right shall be, expressly or impliedly, given or granted to any party by Hitachi Metals, Ltd. under this catalog.
8. Please contact Soft Magnetic Materials Company, Hitachi Metals, Ltd., for any inquiry.

Do not duplicate any part of this catalog without written permission from Hitachi Metals, Ltd.

• Above contact addresses are as of March 2007. The addresses are subject to change without notice.

If you find difficulty contacting Hitachi Metals, please contact below:

• Hitachi Metals Ltd. Corporate Communication Group.

Tel : +81-3-5765-4076 Fax : +81-3-5765-8312

E-mail : hmcc@hitachi-metals.co.jp